

BULLETIN

NO: 24-032
DATE: February 23, 2024
TO: All Personnel
FROM: Ted Moran, Battalion Chief, Logistics Division
SUBJECT: Kearny Mesa Repair Facility

Heavy Fire Fleet Operations will be moving to the new Kearny Mesa Repair Facility (KMRF) located at 8050 Othello Ave in Kearny Mesa. Effective February 26, 2024, all engine and truck company repairs will be done at KMRF except for tire repair. Tire repair will remain at Miramar Pl. until further notice. Additionally, ready reserve apparatus will be maintained at the new facility allowing for changeouts to be done at the same location.

Rose Canyon will remain the identified repair facility for brush apparatus and other auxiliary fire equipment. Service for these apparatus will move to KMRF at a later date.

The new contact information for KMRF:

Fleet Repair Supervisor – (619) 527-8079

Fleet Team Lead – (619) 527-8090

Contact Battalion Chief Ted Moran with any question about the new facility @ (858) 295-2550 or tcmoran@sandiego.gov.

The attached diagram shows the flow path for apparatus when entering KMRF. The most eastern front gate will be open during business hours. Cameras will notify the fleet supervisor when a vehicle has approached the interior gate and will open remotely to allow access.

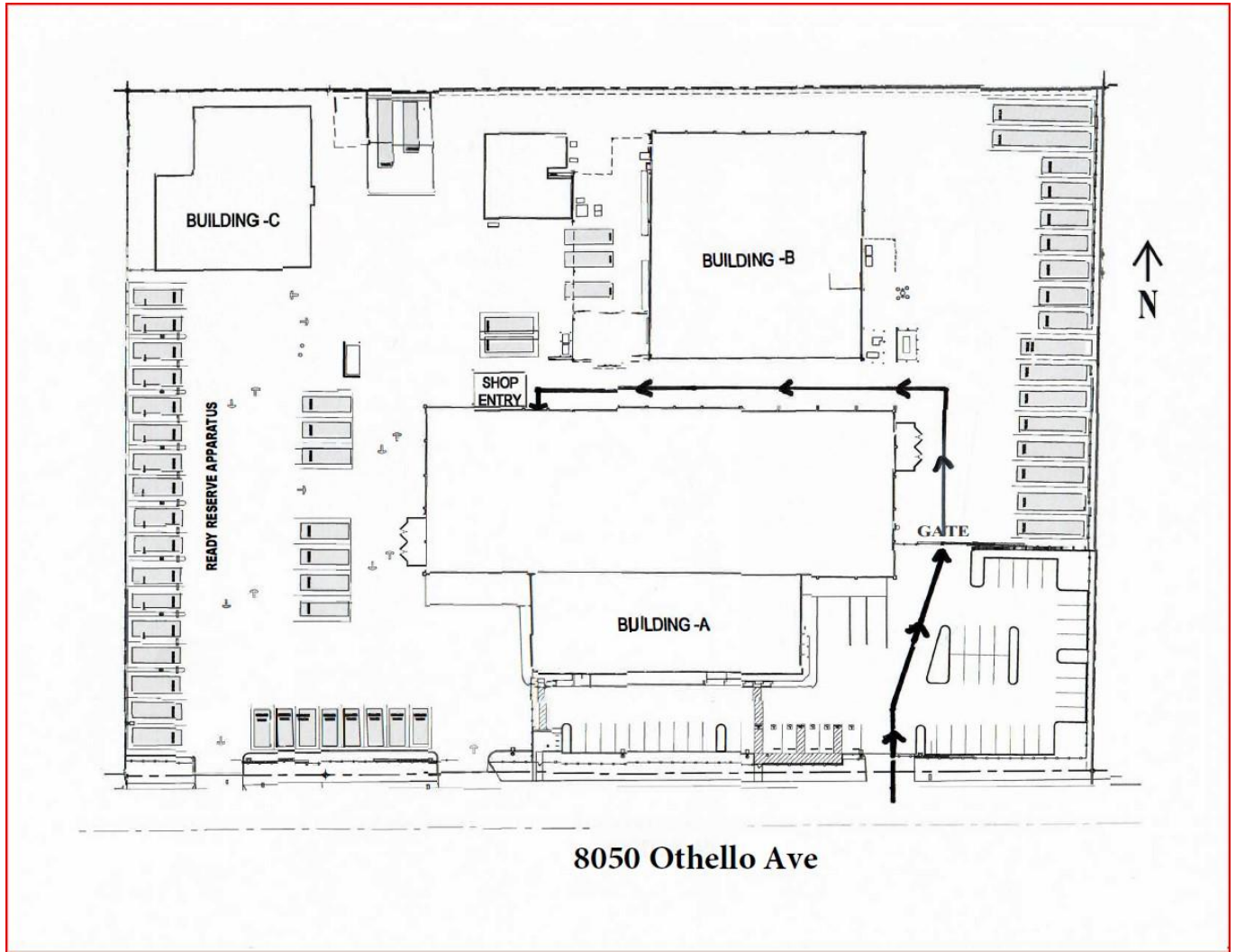

Front Gate on Othello Ave



Interior Gate



Make first left after interior gate (Between the two buildings)



Stop at blue door on left side. Enter to check in with the Fleet Team Lead or Fleet Supervisor



Inside check-in



Contact Battalion Chief Ted Moran with any questions at 858-295-2550 or tcmoran@sandiego.gov.